

Courses & Distances  
 S 78 E. 70 }  
 N 85 E. 62 } Down  
 S 58 E. 46 } Cockatanus  
 N 51 E. 26  
 N 4 E. 36  
 N 25 1/2 E. 39  
 N 47 E. 16  
 S 73 7/8 W 231 1/2

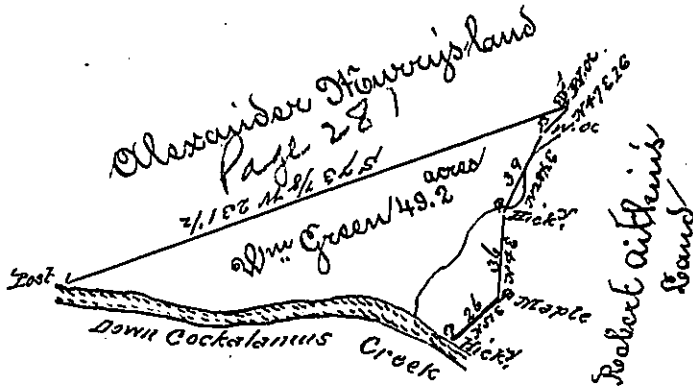

The Draught of a tract of land called Chester situate in Greenwood Township, Cumberland County containing forty nine acres & two tenths of an acre by the usual allowance of six per Cent. for roads &c. surveyed May the 10<sup>th</sup> 1785 for William Green; in pursuance of a Warrant from the Honorable the Proprietaries dated the 20<sup>th</sup> day of Feb<sup>r</sup> 1775—  
 John Embury Esq. Surv<sup>r</sup> Genl.  
 Jas<sup>s</sup> Harris D. D.

IN TESTIMONY that the above is a copy of the original remaining on file in the Department of Internal Affairs of Pennsylvania, made conformably to an Act of Assembly approved the 16th day of February, 1833, I have hereunto set my Hand and caused the Seal of said Department to be affixed at Harrisburg, this first day of November 1898.

*James W. Latta*  
 Secretary of Internal Affairs.